

How to Install Solar Post Caps

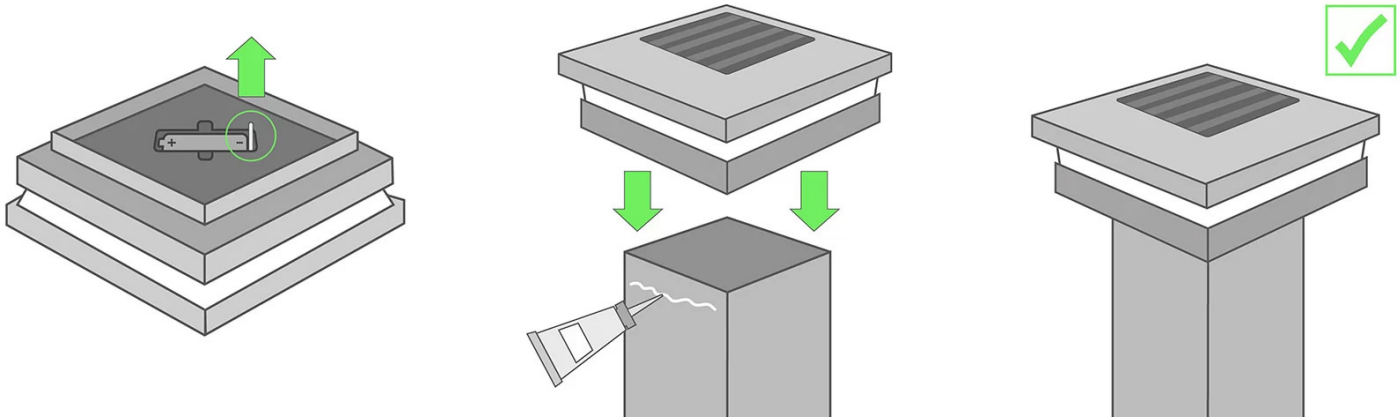

1. Step One

Flip the post cap upside down and locate where the included solar charging battery is. Then, pull the tab on the battery which will complete the circuit, and the cap should light up. If not, refer to the next page for help with troubleshooting.

2. Step Two

Optional, but recommended for high-wind and coastal areas, put a little bit of silicone along the outside and inside line of your post and insert the post cap. Allow for the vinyl glue to dry for at least 30 minutes, 24 hours to completely dry.

3. Step Three

Place the post cap onto your post. Gently push the post cap into place to ensure that it is properly secured on top of your post. Once you have made sure that the cap is secure, your solar post cap is installed!

Keeping your Post Caps Clean

When cleaning your post caps there's absolutely nothing to worry about as it's a simple two step process. To clean the outside of your post cap, you can use any preferred cleaner and a rag or paper towel. Simply spray your rag with the cleaner and wipe down the post cap as needed.

To clean the inside of your post cap, most caps like the one seen here just pop off the post with a light tug, allowing you to perform the same wipe down that was given to the outside of the post cap. For both the inside and outside of the cap, we recommend rinsing with water to avoid any streaking. It's important to remember to reinstall the cap topper properly to allow the cap to charge.



Troubleshooting FAQ:

Q: What if the Light does not turn on?

A: Ensure battery tab is pulled. The light should work instantly when upside-down on a tabletop or placed in darkness. If not, remove and re-insert battery, ensuring spring is compressed, not crushed under battery. If the light still does not turn on, the battery may not be charged or require replacement.



Q: How do I test my Solar Battery?

A: Remove the battery from a known working post cap and replace it with the battery you believe may be faulty. The light should function properly when upside-down on a tabletop or placed in darkness. If the light works, the original battery may not be charged or require replacement.

Q: How to charge my Solar Post Cap battery?

A: Make sure that your caps solar panel is in direct sunlight. The solar battery cannot charge properly if its solar panel is cannot get proper energy. If you do not have access to direct sunlight, solar batteries can be put onto a recharge station or can be replaced.

Q: How to change my Solar Post Cap battery?

A: Remove the post cap from your post and flip it over. Locate the battery and then gently push the battery towards the spring and pull it out. It's important to be gentle and not hurt the battery contacts. Then, simply place the new battery by reversing the steps you took to remove the battery.

Q: What if my Post Cap stops working?

A: If after checking that the batteries are charged and working, contact the manufacturer. LMT offers a [full warranty](#) on all of their vinyl products and are happy to work with you if your product gets damaged or stops working! You can contact them at [\(888\) 570 - 5252](tel:8885705252) for more information.



Looking for Post Caps?

At Solar Post Caps Direct, we offer a wide variety of post caps including Standard, Solar, and Low-Voltage caps in dozens of colors and styles! We also offer a wide variety of other lighting accessories such as landscape lighting, deck and stair accent lights, bistro lights, and more.

Not sure what you're looking for? Contact our expert sales team today to help match you with the perfect post caps for your fence.

[Shop Solar Post Caps](#)

[Contact Us](#)